

Product Installation Guidelines & Scope of Use

Version 1.1, 28 August 2025, Page 1 of 4
Document No.: 174.01.02.01

Vandal Resistant CP Lead Safe™ J/V Wall Top Assembly Cold

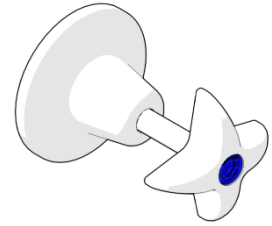

PRODUCT CODES

- 174.01.02.01

SPECIFICATIONS

- Chrome plate finish for easy cleaning and durability.
- Simple servicing and readily available parts.
- Tough vandal resistant handle that has a unique locking system.
- Quality controlled. Every tap is tested.
- Lead Safe™ brass construction*

IMPORTANT: All Vandal Resistant Jumper valve taps are tested in accordance with AS 3718 and leave our premises in good working order.

*Our Lead Safe™ product range is compliant with the Lead-Free Requirements of the NCC 2022 Vol. Three, Clause A5G4(2) and NSF/ANSI 372.

TECHNICAL DATA

Inlet		5/8" BSP - Male
Outlet		N/A
Headwork		Jumper Valve
Working Pressure Range (kPa)	Min	50
	Max	500
Working Temperature Range (°C)	Min	5
	Max	60
Nominal Flow Rate (LPM)		N/A
Construction		Brass
Finish		Chrome
NOTE: Galvin Engineering continually strive to improve their products. Specifications may change without notice.		

TOOLS REQUIRED

- Spanner or adjustable crescent
- Key Spanner (supplied)

PRE-INSTALLATION

DIMENSIONS

Note: Before installation, all lines must be flushed. We recommend that a line strainer be installed prior to drinking taps to eliminate any foreign material.

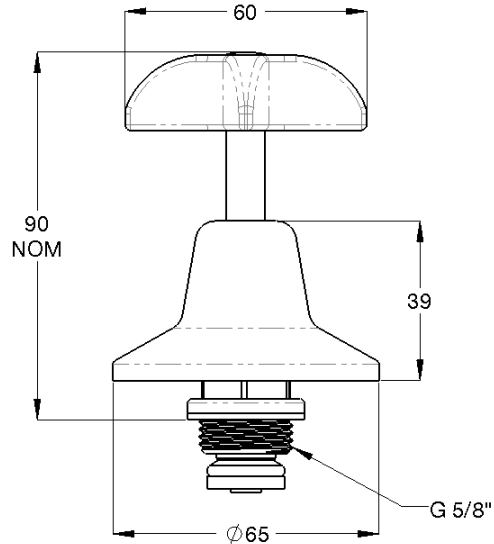

INSTALLATION

IMPORTANT: Galvin Engineering products must be installed in accordance with these installation instructions and in accordance with AS/NZS 3500, the PCA and your local regulatory requirements. Water and/or electrical supply conditions must also comply to the applicable national and/or state standards. Failing to comply with these provisions shall void the product warranty and may affect the performance of the product.

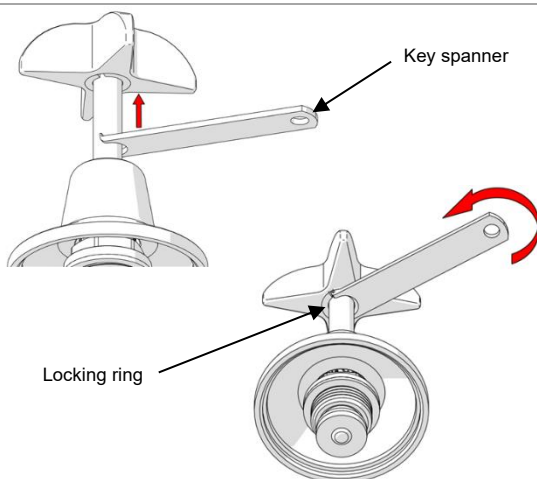

1. Remove locking ring

- Using supplied key spanner, unscrew the handle assembly locking ring as shown.

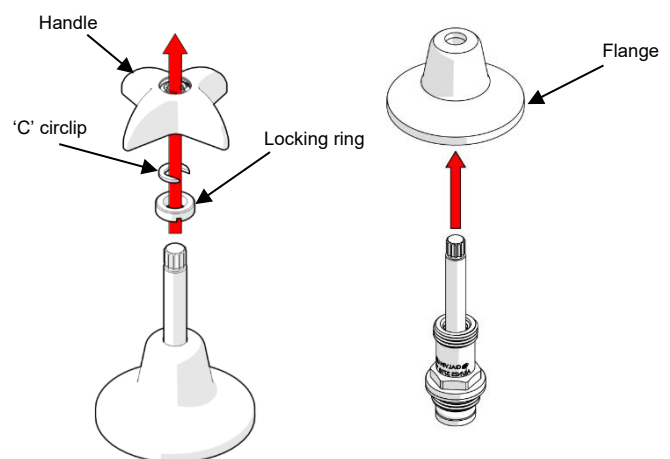

2. Disassemble

- Remove the handle, then 'C' circlip and locking ring.
- Unscrew the flange.

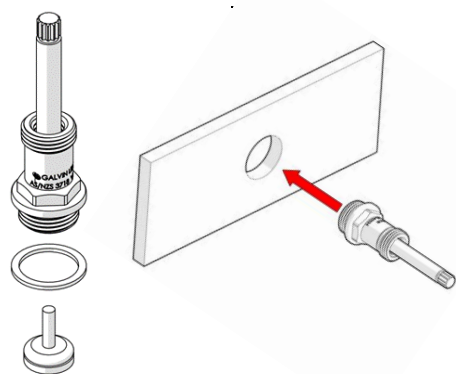

3. Fit top assembly

- Fit top assembly ensuring the tap washer and jumper valve is in place.

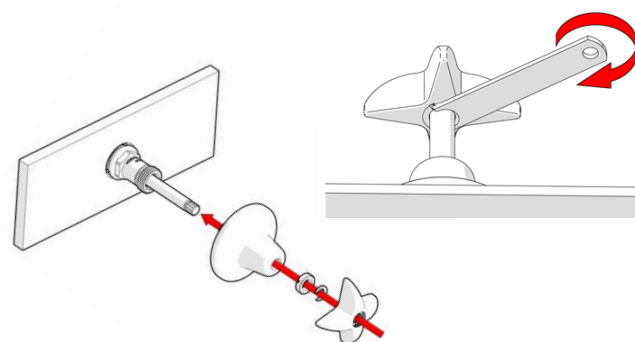

4. Re-assemble

- Fit the assembly components by reversing steps 2 & 1 as shown.

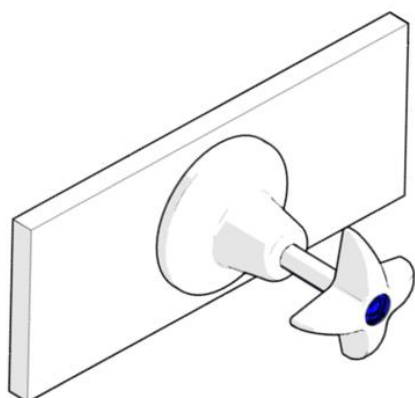

5. Testing

Once the assembly has been installed, test for leaks and correct operation.

TROUBLESHOOTING

PROBLEM	CAUSE	RECTIFICATION
Water is not flowing from tap	Water supply is turned off	Turn on water supply
Assembly is leaking	The supplied tap washer wasn't installed.	Repeat installation steps ensuring the tap washer is correctly in place
Tap is leaking	Worn jumper valve.	Remove the top assembly and replace the jumper valve

WARRANTY

Galvin Engineering products are covered under our Manufacturer's Warranty. Galvin Engineering products must be installed in accordance with the installation instructions and in accordance with AS/NZS 3500 and NCC Volume Three, relevant Australian Standards and local authorities applicable to product being installed. Water and electrical supply conditions must also comply to the applicable national and/or state standards, failing to comply with these provisions may void the product warranty and affect performance of the product.

Please visit www.galvinengineering.com.au to view the full warranty, our Installation Compliance and Maintenance & Cleaning information as well as any other additional information.

Within Australia: **1300 514 074** Outside Australia: P: **+61 (0)8 9338 2344**

F: **+61 (0)8 9338 2340**

sales@galvinengineering.com.au

www.galvinengineering.com.au

ABN: 78 008 719 382

PERTH | SYDNEY | MELBOURNE | BRISBANE | ADELAIDE

